

# Venue 7

## 3000 Series



### User's Manual

Marketing model: Venue 3741  
Regulatory model: T02C  
Regulatory type: T02C001



# Notes, Cautions, and Warnings

---

-  **NOTE:** A NOTE indicates important information that helps you make better use of your computer.
-  **CAUTION:** A CAUTION indicates either potential damage to hardware or loss of data and tells you how to avoid the problem.
-  **WARNING:** A WARNING indicates a potential for property damage, personal injury, or death.

**Copyright © 2014 Dell Inc. All rights reserved.** This product is protected by U.S. and international copyright and intellectual property laws. Dell™ and the Dell logo are trademarks of Dell Inc. in the United States and/or other jurisdictions. All other marks and names mentioned herein may be trademarks of their respective companies.

2014 – 09

Rev. A00

# Contents

<b>Features</b> . . . . .	<b>5</b>
<b>Charging the Battery</b> . . . . .	<b>7</b>
<b>Inserting the microSD Card and Micro-SIM Card (optional)</b> . . . . .	<b>8</b>
<b>Getting Started</b> . . . . .	<b>9</b>
Turning on/off the device . . . . .	9
Finishing Android setup . . . . .	9
Customizing the screen . . . . .	10
Locking and unlocking your device . . . . .	11
Touch tips . . . . .	11
Status bar. . . . .	12
Screen orientation . . . . .	13
Keys and functions . . . . .	13
Apps and widgets . . . . .	13
<b>Using Your Device</b> . . . . .	<b>14</b>
Contacts . . . . .	14
Text entry . . . . .	15
Managing your device's storage . . . . .	15
Calls . . . . .	16
Messages . . . . .	16
Internet . . . . .	17
Email . . . . .	19
Customizing Your Device . . . . .	20

Protecting Your Device . . . . .	21
Apps . . . . .	24
Bluetooth. . . . .	25
Gallery . . . . .	26
Calendar . . . . .	27
<b>Troubleshooting . . . . .</b>	<b>28</b>
<b>Specifications . . . . .</b>	<b>30</b>

# Features

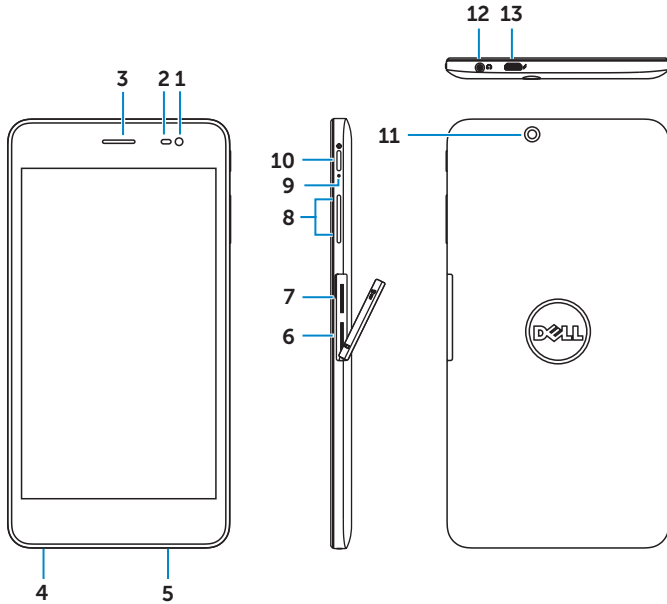

Part	Functionality
1. Front camera	Use to make video calls or to capture front photos and videos.
2. Ambient-light sensor	Detects the ambient light to allow screen-brightness to be adjusted automatically.
3. Earpiece	Used to transfer sound.
4. Microphone	Use for recording sound or to input voice in other voice-based apps.
5. Speaker	Outputs sound.
6. Micro-SIM card slot	Insert a micro-SIM card to access mobile broadband.
7. MicroSD-card slot	Insert a microSD card to expand the storage on your device.
8. Volume buttons	<ul style="list-style-type: none"> <li>• Press to increase or decrease the volume by one level.</li> <li>• Press and hold to continuously increase or decrease the volume.</li> </ul>

---

<b>Part</b>	<b>Functionality</b>
<b>9.</b> Battery-charging status light	When the device is charging, the battery-charging status light flashes.
<b>10.</b> Power button	<ul style="list-style-type: none"><li>• Press and hold to turn on your device.</li><li>• Press and release to lock or unlock the screen.</li><li>• While the device is turned on, press and hold to open the options menu.</li></ul>
<b>11.</b> Rear camera	Capture pictures and videos.
<b>12.</b> Headset port	Connect headphones or headset.
<b>13.</b> Micro-USB port	Connect a USB cable to charge your device or to connect to your computer.

# Charging the Battery

---

**NOTE:** Your device may not be fully charged when you receive it. It is recommended to charge the device for 4 hours for the first time.

**CAUTION:** Use only the power adapter and/or cable that shipped with the device.

1. Connect the micro-USB end of the USB cable to the USB port of the device.
2. Connect the other end of the USB cable to the adapter.
3. Connect the power adapter to an electrical outlet.

An animated icon  appears on the screen while the battery is being charged. When the battery is fully charged, the icon is static.

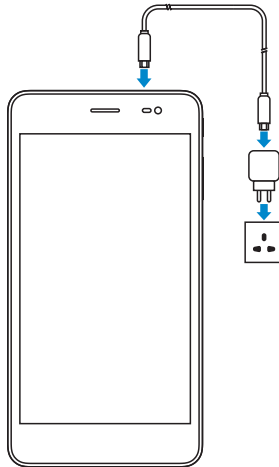

**NOTE:** When disconnecting the device from the adapter, disconnect the power adapter from the power outlet and then disconnect the cable from your device.

# Inserting the MicroSD Card and Micro-SIM Card (optional)

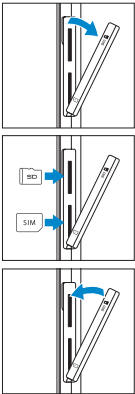
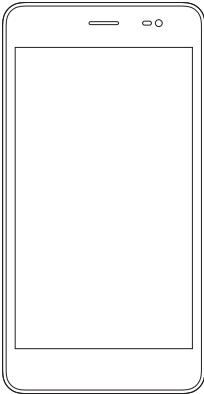

---



Open the card-slot door

Insert the cards into the respective slots and push the cards in until they click in place

Close the card-slot door

-  **NOTE:** Make sure the cards are correctly aligned and are inserted all the way.
-  **NOTE:** Turn off your device before inserting the microSD card and micro-SIM card.



# Getting Started

---

## Turning on/off the device

To turn on your device, press and hold the power button for 3 seconds.

 **NOTE:** When your device is fully discharged, it is recommended to connect the device to the power adapter for charging for 3-5 minutes and then turn on the device.

To turn off your device, press the power button to open the options menu, and then select **Power off** → **OK**.

## Finishing Android setup

After you turn on your device for the first time, follow the prompts on the screen to finish Android setup.

You can configure settings such as language, Wi-Fi, date & time, sign-in to your Google account, and so on.

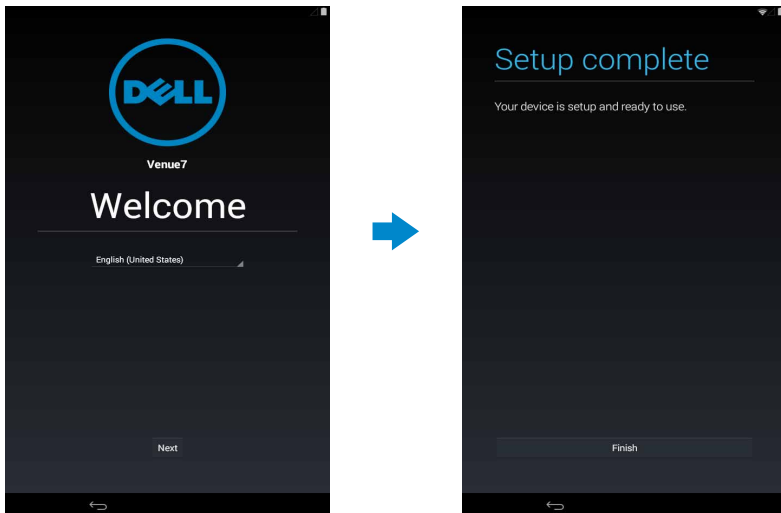

# Customizing the screen

After finishing Android setup, follow the instructions on the screen to customize the home screen.

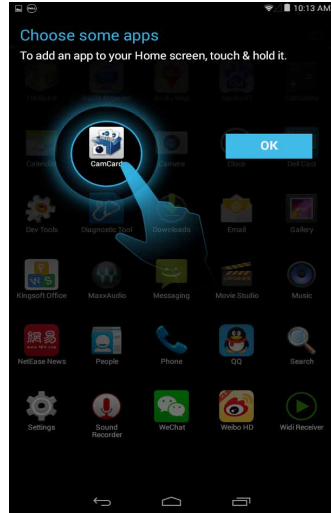
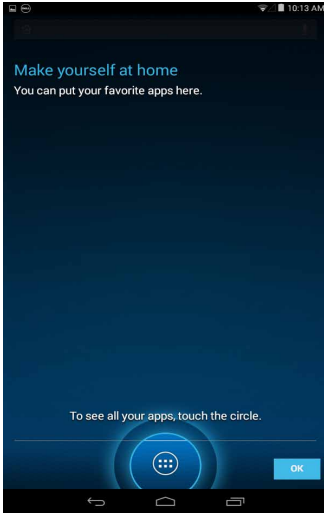

# Locking and unlocking your device

Press the power button to turn off the screen and lock your device.

You can also configure your device to automatically lock after a certain period of inactivity.

Tap  → **Settings** → **Display** → **Sleep** to set the time after which you want the device to enter sleep state and lock itself.

To unlock the screen, press the power button and then slide the lock icon  in any direction.

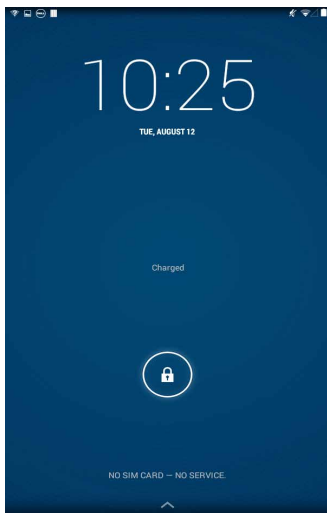

 **NOTE:** The procedure to unlock your device varies depending on the security method you choose.

## Touch tips

Your device supports multi-touch. You can use the touch screen as follows:

- |                 |   |
|-----------------|---|
| Tap             | Touch the screen once to access a menu or select an item.   |
| Tap and hold    | Touch and hold your finger in place.  |
| Slide           | Switch between different home screens.  |
| Drag            | Tap and hold an icon and then move the icon to the target position.   |
| Two-finger zoom | Place two fingers on the screen and move the fingers apart to zoom-in or bring the fingers close to zoom out. You can use zoom-in and zoom-out in maps, photos, web pages, and so on. |

# Status bar

The status bar at the top of the screen displays notifications from apps, time, status of various devices such as battery, SIM card, Bluetooth, and so on.



1. Notification panel displays notification icons to inform you of new emails, missed calls, unread messages, and so on. Slide the panel down to view the notifications and then tap a notification icon to view more details. Tap  to clear all the notifications.

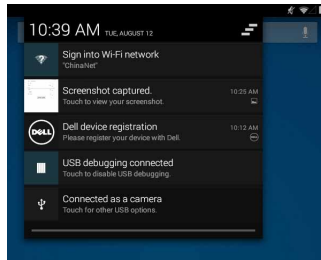

2. Status panel displays the status icons for battery status, alarms, Bluetooth, network connection, and so on. Slide the panel down to access more settings and configuration options.

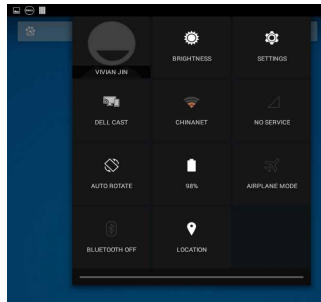

# Screen orientation

For optimal viewing experience, the screen orientation changes automatically depending on how you hold the device.

To toggle auto-rotate, slide down the status panel and tap the **AUTO ROTATE** icon 

# Keys and functions

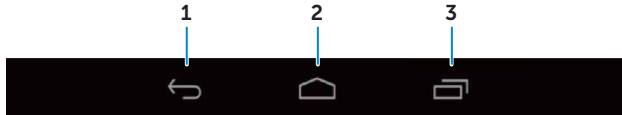

- 1. Back**
  - Tap to return to the previous screen or to exit the current app.
  - In text input mode, tap to close the on-screen keyboard.
- 2. Home**
  - Tap to return to the main screen.
  - Tap and hold to open Search.
- 3. Menu** Tap to open a list of recently-used apps.

# Apps and widgets

- **Apps:** Software that allows you to perform a specific task. Your device is preloaded with a variety of apps, and additional apps can be downloaded from the Play Store.
- **Widgets:** A small app that resides on the home screen and provides quick and easy access to information.

# Using Your Device

---

## Contacts

To view and manage your contacts, tap  → **People**.

### Creating a contact

1. Tap  → **People** → **Create a new contact**.
2. Sign in to an existing Google account or create a new Google account to back up your contacts online or choose the option to save the contacts on the device to keep local.
3. Enter the contact information using the on-screen keyboard and then tap **Done** to save the contact.

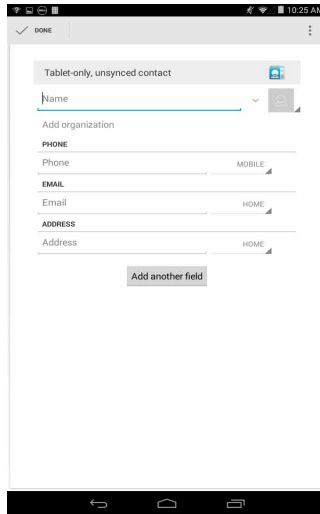

### Searching for a contact

To locate a contact:

- Scroll through the contact list until you find the desired contact.
- Tap  to open the search bar, and then type either the contact's full or partial name in the **Find contacts** box. A list of matching contacts is displayed.

After you locate the desired contact, tap the contact's entry to view the details.

# Text entry

You can type text using the on-screen keyboard. To open the on-screen keyboard, tap a text box. To close the keyboard, tap the back key .



- Tap to type letters.
  - Tap and hold to type numbers.
- Tap to delete a character, symbol, or a space to the left of the cursor.
  - Tap and hold to delete text to the left of the cursor.
- Tap once to show the uppercase keyboard for typing a capital letter.
  - Tap twice to enable the Caps Lock mode and tap once to change back to the lowercase mode.
- Tap to use voice input. The device enters the words that it can recognize.  
 **NOTE:** It is recommended to speak close to the microphone and use this feature in a quiet environment to improve speech-recognition accuracy.
- Tap to display the keys for typing numbers and punctuation marks.

# Managing your device's storage

## Checking storage space

Tap  → **Settings** → **Storage**. The used, unused, and total space on the device's internal storage and microSD card is displayed.

## Erasing app data and cache

1. Tap  → **Settings** → **Apps** → **DOWNLOADED/RUNNING/ALL**.
2. From the **Apps** list, tap the app whose cache or data you want to remove.
3. In the app screen, tap **Clear cache** or **Clear data**.

## Un-mounting the SD card

1. Tap  → **Settings** → **Storage**.
2. Tap **Unmount** → **OK** to remove the SD card.



△ **CAUTION:** It is recommended that you unmount the SD card before removing it. Removing the SD card while it is in use may cause data loss or result in app errors.

## Erasing all data from your device

△ **CAUTION:** Performing these steps erases all data, including your personal information and downloaded apps from your device. Make sure that you back up all the required data before you proceed.



1. Tap  → **Settings** → **Backup & reset** → **Factory data reset**.
2. Tap **Reset tablet**.
3. Read the warning and tap **Erase everything**.

## Calls

1. Tap the Phone icon  on the home screen.
2. Tap the dialpad icon .
3. Enter the phone number and then tap the phone icon  to dial the number.

 **NOTE:** You need to activate your network service before making a call.

## Messages

1. Tap the Messaging icon  on the home screen.
2. Tap the new message icon .
3. Type the message in the **Type message** field.
4. Enter the phone number in the To field and tap the send icon .

 **NOTE:** You need to activate your network service before sending a message.



# Internet

You can connect your device to Wi-Fi or mobile networks to access the Internet.



## Connecting to the Internet using Wi-Fi

 **NOTE:** The range and quality of the Wi-Fi signal is affected by the distance between the device and the wireless router, the number of connected devices, infrastructure, and objects through which the signal is transmitted.

1. Tap  → **Settings** → **Wi-Fi**.
2. Enable **Wi-Fi** by moving the slider to **On** position. The device scans for Wi-Fi networks in range.
3. Tap the network you want to connect to.
4. Type a password (if connecting to a secure network) and tap **Connect**.



 **NOTE:** To connect to a secured Wi-Fi network, you must type the security key. If you do not have the security key, contact the person who manages your Wi-Fi network or contact the router manufacturer.

 **NOTE:** To start a new search for available Wi-Fi networks, tap  → **Scan** on the Wi-Fi screen.

## Connecting to the Internet using mobile broadband

1. Tap  → **Settings** → **Wi-Fi**, then touch **Wi-Fi** to disable it.
2. The device automatically searches for the signal and connects to the network.
3. When the device is connected to a mobile-broadband network, the network type appears in the status bar.

## Using the airplane mode

Putting the device in airplane mode disables all mobile and Wi-Fi connections. This feature is useful when wireless connectivity is strictly prohibited, such as on an airplane.

To enable airplane mode, tap  → **Settings** → **More...** → **Airplane mode**.

## Browsing the Internet

### Opening Chrome

Tap  → **Chrome** to open the chrome app.

### Using the Chrome controls bar

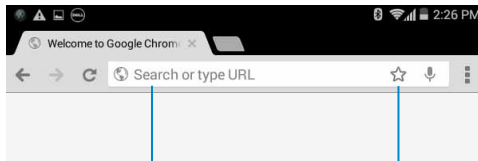

Enter the webpage address

Add to the bookmark

### Viewing web pages

Slide your finger horizontally or vertically on the screen to scroll and view desired areas of a web page.



Zoom-in or zoom-out using the two-finger zoom.

Double-tap the desired area of a web page to switch between the magnified or normal views of the area.

# Email

You can create POP3, IMAP, and exchange email accounts from web-based email services on your device.

## Opening the email app

Tap  → **Email** .

## Setting up an email account

1. On the email screen, type the email address and password of the email account (the same as the account on your computer).
2. Tap **Next** to display the account options screen to configure your email options.
3. After configuring the account options, tap **Next** to access your email.

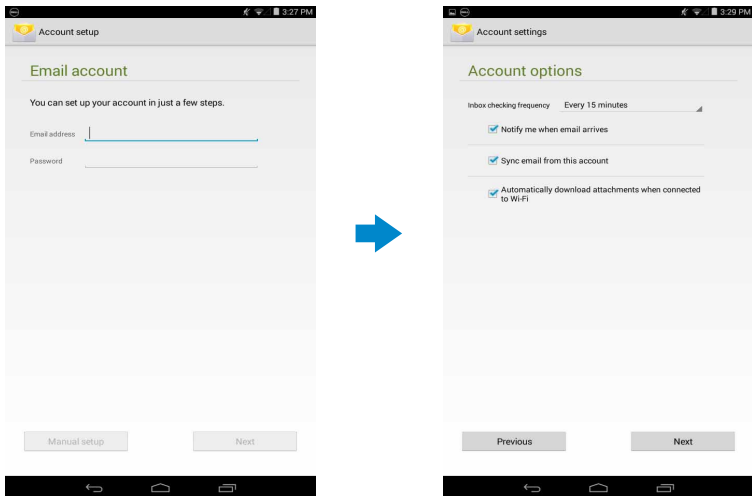



## Adding other email accounts

In the email screen, tap  → **Settings** → **ADD ACCOUNT** to set up another email account.

## Deleting an email account on your device

1. In the email account screen, tap  → **Settings** and then select the account you want to delete.
2. Tap **Remove account** and tap **OK**.

## Creating and sending emails

1. Tap  → **Email**.
2. Select an email account to use, if you have more than one account on your device.
3. Tap  to compose a new mail.
4. Type the recipient's email address in the **To** field. If you are sending the email to multiple recipients, separate their email addresses with a comma.
5. Type the subject in the **Subject** field.
6. Compose your email content.
7. Tap  to send the email.

# Customizing Your Device

You can configure settings such as display, sound, network, security and so on, using the **Settings** screen.

## Display settings

Tap  → **Settings** → **Display** and then select the desired item under **Display** settings.

- |             |  |
|-------------|--|
| Brightness  | Drag the slider to the right to increase brightness. Drag the slider to the left to decrease brightness. Tap <b>OK</b> to confirm the adjustment.<br><b>NOTE:</b> If automatic brightness is enabled, your device adjusts the screen brightness automatically based on the surrounding light conditions. |
| Wallpaper   | Select a picture from the gallery, live wallpapers, photos or wallpapers, and then tap <b>SET WALLPAPER</b> to set it as the wallpaper.  |
| Sleep       | Select the time after which the device automatically goes into sleep mode.   |
| Daydream    | Select the pictures or animation to show while the device is docked or being charged.  |
| Font size   | Set your device's font size from <b>Small, Normal, Large, and Huge</b> .   |
| Cast screen | Mirror the screen to a display device.   |

## Sound settings

To change the sound and ringtone settings:

Tap  → **Settings** → **Sound** and then select the desired item under **Sound** settings.

Volumes	Adjust the volume for music, videos, games, notification, and alarms.
Phone ringtone	Set the ringtones of the phone.
Default notification sound	Select a default ringtone for notifications.
Dial pad touch tones	Configure whether a sound is played when the dial pad is touched.
Touch sounds	Configure whether a sound is played every time you touch the screen.
Screen lock sound	Configure whether a sound is played when the screen is locked.

## Date, time, and time zone

Your device automatically uses the network-provided date, time, and time zone by default.

To manually set the date, time, and time zone:

1. Tap  → **Settings** → **Date & time**, and disable the automatic date, time, and time zone.
2. Configure options such as the date, time, time zone, time format, and date format.

## Protecting Your Device

You can protect your device against unauthorized access by setting a face unlock, a pattern, a PIN, a password, or with a face unlock. After you configure any of these security options, your device prompts for the respective unlocking information before you can use the device.

### Screen-unlock pattern

This security method requires you to create a pattern that you need to draw every time to unlock the device.

If incorrect unlock patterns are drawn for five consecutive times, the device forces a 30-second delay before you try again.

## Creating a screen unlock pattern

1. Tap  → **Settings** → **Security** → **Screen lock** → **Pattern**.
2. Drag your finger to draw the unlock pattern by connecting at least four dots in a vertical, horizontal and/or diagonal direction. Take your finger off the screen when a pattern is drawn.  
The device records the pattern if it is correctly drawn.
3. Tap **Continue**.
4. Draw the pattern again and then tap **Confirm**.

## Disabling or changing the screen unlock pattern



1. Tap  → **Settings** → **Security** → **Screen lock** → **Pattern**.
2. Draw your existing pattern.
3. Select **None** to disable screen unlock security or select **Pattern** to draw a new unlock pattern.

## PIN

This security method requires you to type a PIN to unlock the device.

If incorrect unlock PINs are entered for five consecutive times, the device forces a 30-second delay before you can try again.

## Creating a PIN

1. Tap  → **Settings** → **Security** → **Screen lock** → **PIN**.
2. On the **Choose your PIN** page, type a PIN in the text box.  
 **NOTE:** Your PIN must be at least 4 characters.
3. Tap **Continue** to proceed.
4. Type the PIN again to confirm.
5. Tap **OK**.

## Disabling or changing PIN



1. Tap  → **Settings** → **Security** → **Screen lock** → **PIN**.
2. Type your existing PIN.
3. Select **None** to disable the PIN or select **PIN** to change the PIN.

## Password

This security method requires you to enter a password that you need to enter every time to unlock the device.

If incorrect unlock passwords are entered for five consecutive times, the device forces a 30-second delay before you can try again.

### Creating a password

1. Tap  → **Settings** → **Security** → **Screen lock** → **Password**.
2. On the **Choose your password** page, type a password in the text box.  
 **NOTE:** Your password must be at least 4 characters long and must contain an alphabet/letter.
3. Tap **Continue** to proceed.
4. Type the password again to confirm.
5. Tap **OK**.

### Disabling or changing the password

1. Tap  → **Settings** → **Security** → **Screen lock** → **Password**.
2. Type the password you have enabled.
3. Select **None** to disable the password or select **Password** to change password.

## Protecting your SIM card with the SIM lock password

You can protect your SIM card against unauthorized use with a PIN. After a PIN is enabled to lock your SIM, you will need to enter the PIN each time you turn on the device in order to unlock your SIM.

-  **CAUTION: The SIM card will be permanently locked if you enter the incorrect PIN for three consecutive times. You must then enter the Personal Unblocking Key (PUK) to unlock the SIM card. Contact your service provider to obtain the PUK.**

# Apps



## Camera

Your device has a camera that allows you to capture and share high-quality pictures and videos.

### Using the camera app

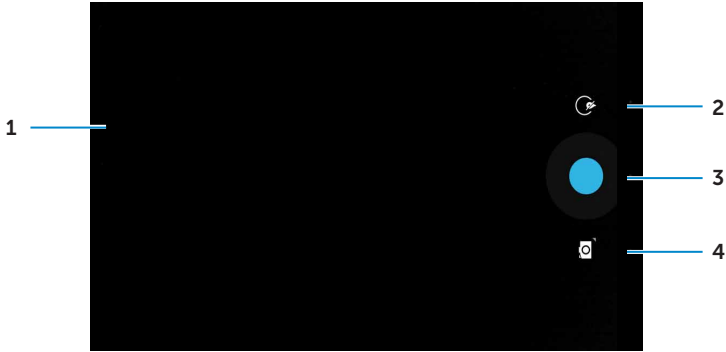
Tap  → **Camera** to open the app.



1. Viewfinder screen.
2. Tap to open or close the camera setting options.  
Tap  and then tap  or  to switch between front and rear camera.
3. Tap to capture a picture or to record videos when the camera is in video mode.
4. Tap to switch between the camera mode for capturing pictures and the video mode for shooting videos.

## Copying files to and from the device

You can transfer files between your device and computer using the device's internal storage or the optional microSD card. To transfer files, connect the device to your computer using the micro-USB cable.

### Setting the SD card or the internal device storage as a USB drive

1. Connect the device to the computer by connecting the micro-USB end to the device and the other end to your computer.
2. The USB notification icon  appears in the status bar's notification area when your device is connected to the computer.
3. Select **Connected as a Media device** if you want to transfer files between your computer and the device.
4. Open **My Computer** on your computer to locate the removable drive, which represents the SD card installed in your device and the internal device storage.



5. Copy the desired files such as music or pictures from your device to the computer, or vice versa.



**NOTE:** The steps above are applicable to Microsoft Windows.

## Bluetooth

Bluetooth is a short-range wireless communications technology that lets your device connect to other Bluetooth devices such as headsets, computers, other mobile devices, and so on.

Turning on Bluetooth allows your device to detect nearby Bluetooth devices and automatically connect to devices that are already paired.

### When Bluetooth is turned on, you can also set the following:

- **Visible:** Other Bluetooth devices can detect your device.
- **Invisible:** Other Bluetooth devices cannot detect your device. However, devices that are already paired can connect to your device.

### Turning on Bluetooth and making the device discoverable

1. Tap  → **Settings** → **Bluetooth**.
2. Tap **ON** to turn on Bluetooth.
3. Tap **Visible to all nearby Bluetooth devices** to make the device discoverable by other nearby Bluetooth devices.

### Pairing and connecting a Bluetooth device

1. Turn on Bluetooth.
2. In the **AVAILABLE DEVICES** list, tap the device that you want to connect to.  
 **NOTE:** To search for devices again, tap **SEARCH FOR DEVICES**.
3. To initiate a connection with a device, tap the name of the device.
4. When the pairing is successful, the paired device can be automatically connected.
5. If more than two devices are paired, you have to tap one of the paired device so that it can be connected.

### Ending a Bluetooth connection

On the Bluetooth connection page, tap the connected device to end the Bluetooth connection.





**NOTE:** If you are ending a Bluetooth connection from a headset or keypad, a pop-up window alerts you. Tap **OK** to continue to end the Bluetooth connection.

### Unpairing



On the Bluetooth connection page, tap  → **Unpair** to erase all pairing information with that device.

# Gallery





To view and manage the pictures and videos stored on your device, tap  → **Gallery** .

## Sharing or deleting albums

All pictures and videos are grouped in separate albums according to their dates, sources, or folders in which they are stored. For example, pictures taken using the device are grouped as **Camera**, and downloaded pictures are grouped as **Download**.

1. Tap and hold an album until the options appear.
2. Tap and hold more albums if you want to do the same task for these albums.
  - To share the selected albums using **Bluetooth**, **Google+**, **Email**, **Picasa**, and so on, tap .
  - To delete the albums, tap .

## Browsing pictures and videos

1. Tap an album to display the thumbnails of all pictures and videos in the folder.
2. To browse the pictures or videos, scroll through the thumbnails until the desired thumbnail is located.
3. To select a thumbnail, tap and hold it until the options appear.
4. Tap and hold more thumbnails as you need.
  - To share the selected pictures or videos using **Bluetooth**, **Google+**, **Email**, or **Picasa**, tap .
  - To delete the selected pictures or videos, tap  → **Delete**.
  - To set a picture as the wallpaper, tap the picture until the options appear and then select  → **Set picture as** → **Wallpaper**.
  - To set a picture as the contact photo, tap and hold the picture until the options appear and then select  → **Set picture as** → **Contact photo**.

## Displaying a full picture

Tap a desired picture to display the picture in full screen.

- Slide left or right to view the previous or next picture.
- To open the picture viewing controls, tap anywhere on the picture.

# Calendar

Use the calendar to schedule and manage your events, meetings, and appointments.

## Opening the calendar

Tap  → **Calendar** to open the app.

## Adding a new event

1. On the **Calendar** screen, tap  to open the new event details screen.
2. Type the event name, location, description and configure options such as time period, repetition, reminders and so on.
3. Tap **DONE** to save the event.



# Clock

Use the clock to set alarms, countdown, stopwatch, and so on.

## Opening the clock

Tap  → **Clock**.

## Setting an alarm

1. On the **Clock** main screen, tap  to enter the alarm main screen.
2. On the alarms screen, tap  to add an alarm.
3. Tap **DONE**.
4. Tap  → **Settings** to configure settings such as the alarm volume, snooze length, and so on.

# Troubleshooting

---

<b>Security Problems</b>	<b>Possible causes</b>	<b>Possible solutions</b>
The SIM card's PIN code is blocked.	You have entered an incorrect PIN code three consecutive times.	Contact your service provider to get the PUK code.
System problems		
Battery does not charge.	The battery or battery charger is damaged.	A possible cause for this could be the use of incorrect power adapter. Use only the power adapter that shipped with your device.
	The ambient temperature is below 0°C or higher than 40°C.	Adjust the battery charging environment to avoid extreme temperatures.
	Poor contact between the battery and charger.	Check all connectors to ensure that all connections have been properly made.
The device does not power on.	The battery has no charge.	Charge the device.
Shortened standby time.	The duration of standby time is affected by your service provider's system configuration. The same device used with different service providers' systems does not have the same duration of standby time.	If you are located in an area where the network signal is weak, move your location to the area where the network signal is strong or temporarily turn off your device if needed.
	If you are not able to connect to the network, the device continues to send out signals as it attempts to locate a base station. Doing this consumes battery charge and consequently shortens standby time.	Change your location to one where the network is accessible, or temporarily turn off your device or set it to airplane mode.

---

## Messaging problem

---

Unable to send or receive text messages.

Your device is in airplane mode with no wireless connectivity.

Slide the status panel down and then disable airplane mode.

---

The network signal strength is not strong enough.

Try moving to a different location for better signal reception.

---

Unable to send or receive email.

The Internet connection or the email setting is not configured properly.

Check your network connection, and confirm with your email service provider if your email setting has been configured correctly.

---

## Internet problems

---

Unable to connect to the mobile broadband networks.

Invalid SIM card.

Contact your service provider.

---

You are not within the network's service area.

Check the service area with your service provider.

---

Poor signal.

Move to an open space or if you are inside a building, move closer to a window.

---

Your device is in airplane mode with no wireless connectivity.

Slide the status panel down and then disable airplane mode.

---

# Specifications

---

Marketing model	Venue 3741
Regulatory model	T02C
Regulatory type	T02C001
Temperature range	0°C – 40°C (30°F – 104°F)
Battery	4100 mAh
Weight	330 g (0.73 lb)
Dimensions:	
Height	199 mm (7.83 inches)
Width	103 mm (4.06 inches)
Depth	9.85 mm (0.39 inches)
Display:	
Type	6.95 inches TN panel
Resolution	600 x 1024
Pixels per inch (PPI)	170
Camera:	
Rear camera	2 megapixels
Front camera	0.3 megapixel
Processor	Intel Z3735G Quad core 1.33 GHz (Burst 1.8 GHz)
Wi-Fi	802.11 b/g/n
Ports:	
USB	One micro-USB 2.0 port (type B)
Audio	One 3.5 mm audio port
Memory:	
RAM	1 GB DDR3L
Storage	8 GB EMMC
Memory card	MicroSD card up to 64 GB
Bluetooth	4.0
GPS	Yes
Wi-Fi Direct	Yes
Operating system	Android 4.4.4 Kit Kat, upgradeable OTA (Over the Air)